



791133 DL TRAILER ASSEMBLY INSTRUCTIONS

STEP 1 TONGUE ATTACHMENT

- Place the frame (Item #1) with fenders down on a set of saw horses and install the tongue (Item #2) with the safety chain mounting bracket facing up.
- Place a 1/2" flat washer (Item #14) on the two 1/2-13 x 4-1/2" bolts (Item #12) and install the bolts through the U-shaped bracket and tongue.
- Place another 1/2" flat washer (Item #14) on the threaded end of the bolts and install 1/2" locknut (Item #15) and tighten both.

STEP 2 COUPLER AND SAFETY CHAIN

- Install trailer ball coupler (item #3) with two 1/2-13 x 4" bolts (Item #29) and two 1/2" lock nuts (Item #15) and tighten.
- Fasten two safety chains (Item #18) to the safety chain mounting bracket using two 3/8 x 1 1/2" hex bolts (Item #13), two 7/16" flat washers (Item #19) and two lock nuts (Item #24) and tighten.
- Slide the jack stand (Item #4) into jack mounting bracket and secure with bent pin (Item #22) and hair pin (Item #27).

STEP 3 WIRING

- Place two grommets (item #16) in the large holes located on the inside of the frame rails near the rear cross member.
- Beginning at the back of the tongue (Item #2), separate the wires on the wiring harness (Item #21) and route one brown wire and the yellow wire through the 1/2" square conduit to the left front of the trailer and down the left side to the rear of the trailer. Repeat the process with the other brown wire and the green wire on the right side of the frame. (REMEMBER, THE TRAILER IS UPSIDE DOWN) Push the wires through the grommet and out of the hole in the end of the frame. Push wires into properly marked terminals on back of the tail lights (Items #7 & 8-left light is the one with clear lens on the bottom). Place studs on left light into holes in tail light guard, place license bracket (Item #16) on studs and install brass hex nuts provided. Place studs on right light into holes on right taillight guard and install brass hex nuts. Nuts must be tightened enough to allow contact with the frame (ground).
- Gently pull any slack in the wires back through the conduit to the rear of the tongue.
- Mount the clearance lights (Items #10) onto brackets provided at each front corner of the frame with brass hex nuts. Again, the washer must penetrate the paint to allow contact with the frame. Route the brown wires from the clearance lights under the frame and connect to the brown and brown/yellow wires in the harness with the blue tap connector (Item #31).
- Attach the white ground wire to the center frame member with the self-tapping screw (Item #28) in the hole provided.
- Push connector end of the wiring harness (Item #18) through the tongue and out the front.

STEP 4 SPRINGS AND AXLE ASSEMBLY

- Slip the back of the slipper springs (Item #5) into the rear mounts and bolt the spring eye into the front mount using the 9/16 x 3 GR 5 bolts (Item #25) and lock nuts (Item #26). DO NOT TIGHTEN AT THIS TIME.
- Set the axle (Item #6) on top of the springs and align the spring center bolt with the hole in the axle opposite the axle plate.
- Use the four u-bolts (Item #20) to go around the spring and through the axle plate to bolt on the axle. Use eight 1/2" lock washers (Item #30) and eight 1/2" hex nuts (Item #23) and torque to 50 ft. lbs. (check torque again after 100 miles and periodically thereafter). Now tighten the lock nuts on the 9/16" spring bolts (Item #26).
- Bolt the tire and wheel assemblies (Item #11) using ten 1/2-20 lug nuts (Item #17) with the valve stem facing out and the tapered side of the lug nut facing the wheel. Torque lug nuts to 60 to 90 ft. lbs. (check torque again after 100 miles and periodically thereafter).

STEP 5 MOUNT DL SERIES DEBRIS LOADER TO TRAILER

- Carefully turn the trailer over onto its wheels. It is recommended to turn it sideways, first onto one tire and then set it down on the second. If you turn the trailer over on the taillights, damage may occur.
- Use supplied hardware to attach the Debris Loader to the trailer. There are six attachment points.



DL Trailer Part drawing

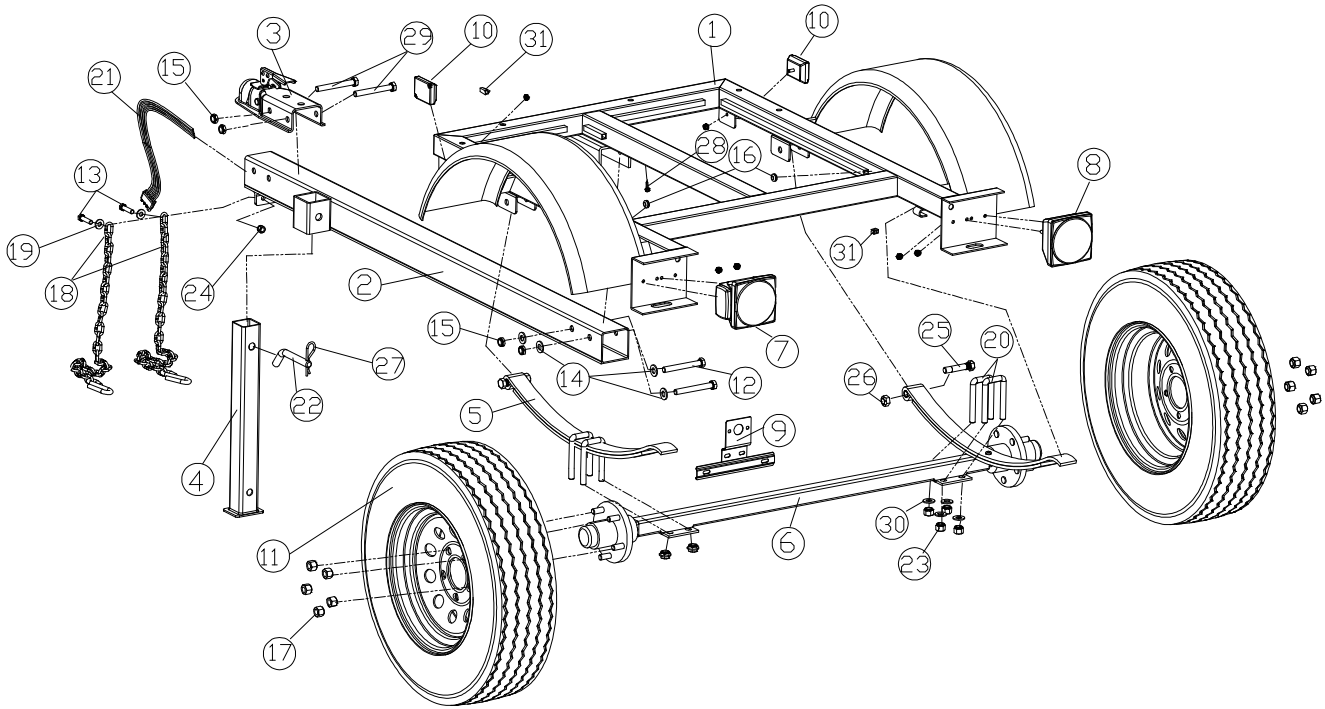

DL Trailer Parts list

Note: Items #24 (Nut-qty 6), #32 (Screwcap-qty 6), and #33 (Washer-qty 12) will be used to mount your debris loader to the trailer

ITEM NO.	PART NO.	DESCRIPTION	QTY
1	791145	FRAME TRAILER WA	1
2	791146	TONGUE TRAILER	1
3	790195	COUPLER 2" BALL	1
4	790193	JACK TRAILER	1
5	790196	SPRING 500LB SLIPPER	2
6	791147	AXLE W/ HUBS TRAILER	1
7	790202	LIGHT REAR RED LH	1
8	790234	LIGHT REAR RED RH	1
9	790235	BRACKET LICENSE	1
10	790201	LIGHT FRONT AMBER	2
11	791148	WHEEL AND TIRE ASSY 13"	2
12	8041106	SCREWCAP 1/2"-13 X 4 1/2" HCS ZP	2
13	8041051	SCREWCAP 3/8"-16 X 1 1/4" ZP	2
14	8172011	WASHER FLAT 1/2" SAE	4
15	8161044	NYLON INSERT LOCKNUT 1/2-13 UNC	4
16	791082	GROMMET 3/8 I.D. 3/4 HOLE	2
17	790208	NUT LUG	10
18	790199	CHAIN SAFETY 32" W/ HOOK	2
19	8172009	WASHER 7/16" SAE 13/32 X 3/16 X 1/16	2
20	790203	BOLT U .5 DIA X 1.25 X 3.5	4
21	791149	WIRE HARNESS 15'	1
22	790205	PIN HITCH	1
23	8160005	NUT 1/2-20 GRADE 2	8
24	8160003	NUT NYLOCK 3/8-16	8
25	790209	BOLT SHACKLE 9/16-18 X 3" GR 5	2
26	790323	HEX NUT 9/16-18 ZP	2
27	790207	HAIR PIN	1
28	890359	SCREW 1/4"-20 X 5/8" HWH	1
29	8041107	SCREWCAP 1/2-13 X 4 1/2" HCS ZP	2
30	790210	WASHER LOCK SPLIT 1/2	8
31	810673	CONNECTOR TAP IN SQUEEZE	2
32	8041058	SCREWCAP 3/8"-16 X 3" HCS ZP	6
33	8171004	WASHER 3/8" FC	12



Wiring Diagram

